

SONET4: Cat5 Audio Distribution System - 4 in / 4 out

The highly successful 'So.net' Sound-over-Ethernet System has been designed to simplify and speed up installations where multiple microphone or line level inputs need to be situated a distance from the amplifier equipment.

Types of installation include churches, schools, theatres and corporate boardrooms.

It is an extremely versatile and cost effective installation device that removes the need for multiple cable runs from remote audio inputs to the amplifier equipment. The SONET4 System can transmit up to four microphone or line level signals down one screened Cat5e cable for up to 1000m.

Each input and output can be independently configured for balanced or unbalanced signals as well as line level or microphone level. There is also an option to provide phantom power to the microphone inputs independently.

Each unit fits neatly into a standard UK double-gang back box and only requires a power supply at the output or amplifier end (PSU supplied as part of system).

Features:

- Reduces installation time
- Up to 1000m between Input and Output plates
- Very high interference immunity
- Balanced or unbalanced inputs & outputs
- Line or Microphone level inputs & outputs
- Phantom powering (max. 15v DC)
- Four XLR sockets on standard 2 gang plates
- No power required at input module
- Power Supply included as part of system

Suggested System Diagram:

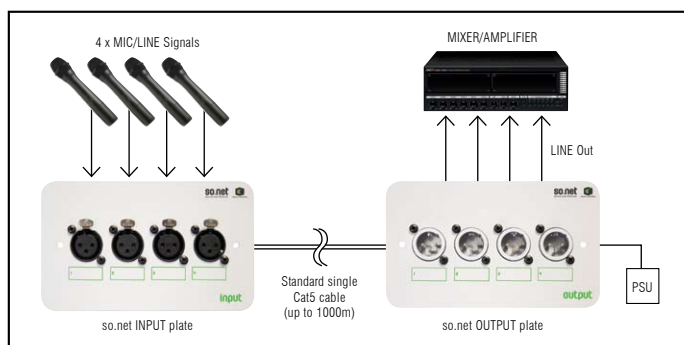

PLEASE NOTE:

When using Cat5 UTP (unshielded) cable, the So.Net system is only capable of transferring up to 3 channels. STP (shielded) Cat5 cable will allow for the maximum 4 channels.

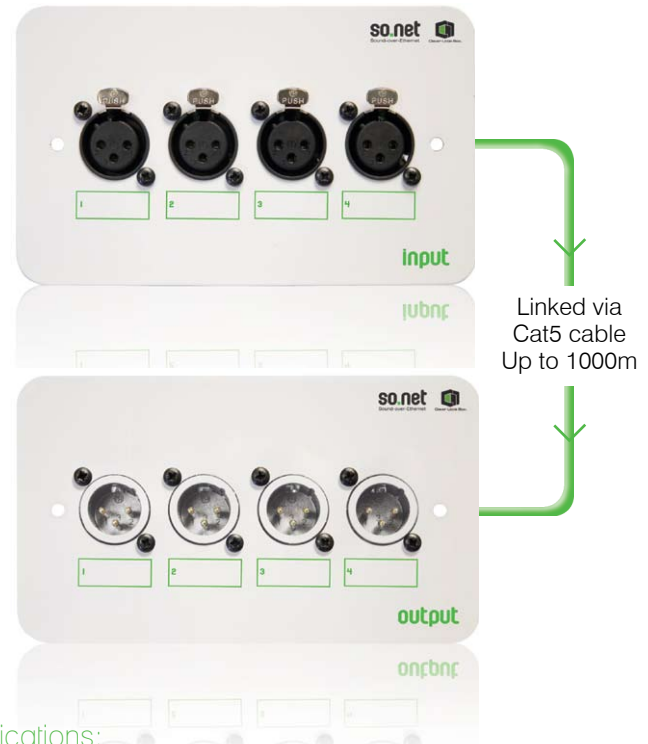

Specifications:

Input Module:

| | |
|-------------------|--|
| Power | Over Cat5 cable |
| Ground | Over Cat5 cable screen (or spare pair) |
| Inputs x 4 | Balanced XLR female |
| MIC/LINE In | Selectable by jumper |
| Phantom Power | 15v jumper selectable |
| MIC Impedance | 600Ω |
| MIC Level Input | 10mV RMS |
| LINE Impedance | 50KΩ |
| LINE Input Level | 700mV RMS (1.5v RMS max) |
| Cat5 Terminations | Screw terminals |

Output Module:

| | |
|--------------------|--|
| Power Requirements | 24v DC @ 100mA (regulated linear power supply recommended) |
| Outputs x 4 | Balanced XLR male |
| MIC/LINE Out | Selectable by jumper |
| MIC Out Impedance | 600Ω |
| MIC Level Output | 20mV RMS (into 600Ω) |
| LINE Out Impedance | 20KΩ |
| LINE Level Output | 700mV RMS (into 20K) |

General:

| | |
|-----------------------|--|
| Channels | Four, individually configurable |
| Bandwidth | 100Hz to 20KHz (-3dB) |
| Crosstalk | > 60dB |
| Signal to Noise Ratio | > 60dB |
| Cable Spec | Screened Cat5e cable (can use UTP but one pair required for ground meaning only three channels would be available) |
| Cable Length | 1000m maximum |
| Cat5 Terminators | Screw terminals |

Protected against short circuit on Cat5 cable to ground