

BOA02

RJ45 Break Out Adaptor - Four Port - Straight Through

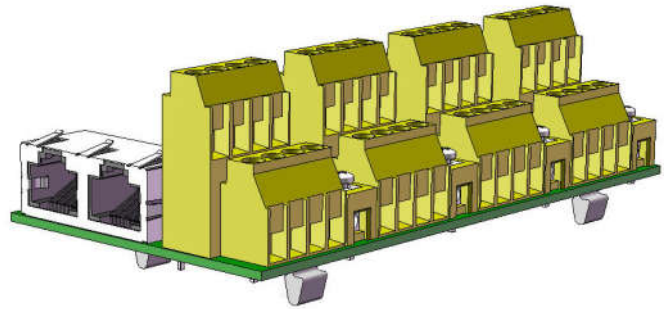

- DIN rail mount
- Break out of all of the connections from four RJ45 ports, each to eight screw terminals plus an output cable screen terminal
- Cost effective straight-through RJ45 connection breakout

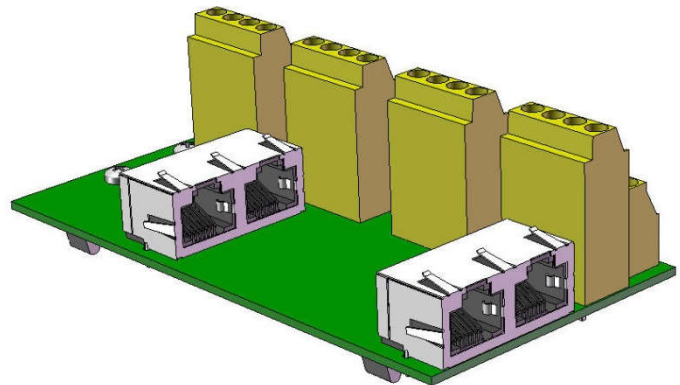

The BOA02 is a simple Quad DIN Rail mount RJ45 cable Break Out Adaptor, which can be used to provide connections from non-RJ45 installation wiring to ASL VIPEDIA-12 IP Audio routers, and to similar equipment with RJ45 connections.

The BOA02 has four RJ45 I/O ports and four blocks of eight terminals, plus four screen terminals. The four pairs of signals from each RJ45 port are each taken to a pair of terminals on one of the terminal blocks, and each terminal block has an associated screen connection which is taken to the RJ45 connector's screen.

Datasheet

ASL Document Ref.: ASL_Datasheet_BOA02_V04.docx
Issue: 04 Complete / Approved 20/04/22

SPECIFICATION

RJ45 Connectivity

I/O Connection Ports 4
Screened RJ45 8 way
All four pairs of RJ45 signals taken to individual I/O Signal Terminal Pairs
The Audio signals pairs to each of the four VIPEDIA-12 Audio Input Ports are connected to a pair of I/O Terminals each
The connector screen is taken to the appropriate screen terminal

I/O Terminal Connectivity

Terminal Blocks 4 eight way terminal blocks, one per RJ45 I/O connection port
One terminal block plus one cable screen terminal per RJ45 port
I/O Terminals per RJ45 port 8 Signal Terminals in four pairs, one pair for each twisted pair in the RJ45 cable
Lower Row of I/O Terminals 4 Signal Terminals, as two pairs
Upper Row of I/O Terminals 4 Signal Terminals, as two pairs
Cable Screen Terminal Single output cable screen terminal

Dimensions

Overall Dimensions (H x W x D) / Weight 35mm x 61mm x 117mm / 0.1 kg
Two of the RJ45 cables will overhang the end of the BOA, adding approximately 50mm to the effective length

Environmental

Temperature -20°C to +50°C (storage and operation)
Humidity Range 0% to 93% non-condensing

Product Part Codes

BOA02 RJ45 DIN TERMINAL BREAKOUT ADAPTOR – FOUR PORT – WITH TERMINATIONS

Alternative Product Part Codes

BOA01 RJ45 DIN TERMINAL BREAKOUT ADAPTOR – SINGLE PORT – WITH TERMINATIONS



This equipment is designed and manufactured to conform to the following EC standards:
EMC: EN55103-1/E1, EN55103-2/E5, EN50121-4, ENV50204
Safety: EN60065

Manufacturer

Application Solutions (Safety and Security) Limited
Unit 17 Cliffe Industrial Estate
Lewes - East Sussex
BN8 6JL - UK
Tel: +44(0)1273 405411 Fax: +44(0)1273 405415
www.asl-control.co.uk



Assessed to ISO 9001
LPCB Cert No: 1043QMS

All rights reserved.

Information contained in this document is believed to be accurate, however no representation or warranty is given and Application Solutions (Safety and Security) Limited assumes no liability with respect to the accuracy of such information.