

Salto Neo - Cam Lock Cylinder

The Salto Neo Cam Lock electronic cylinder is specially designed to fit most cabinets equipped with a cam locking mechanism. The cam itself acts as a locking bolt and is directly operated when the card is presented by the user and turns the plug. The cam rotates between 180 and 90 degrees, securing the lock. This patented system provides an extra level of protection from intrusions with a high security blocking mechanism that is exclusive to SALTO.



Features

- Salto SVN and BLUEnet Wireless network capable.
- All communication between the carrier and the electronic cylinder is encrypted and secured.
- The batteries can be replaced without cylinder removal.
- Optical signalling through light ring. Dual colour green/ red to indicate access authorisation. Acoustic signal optional.
- Equipped with anti-drilling protection.
- Optional torx screw to tighten the knob and convert the cylinder on a fixed knob cylinder.
- Emergency opening via portable programming device (PPD).

Technical characteristics

- Available from 1mm to 22mm door thickness.
- Easy installation on steel lockers or wooden doors.
- Different cam lengths: 28mm or 40mm included.
- 19mm body diameter.
- Security collar included for an accurate installation.

Technical drawing

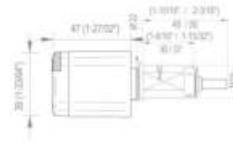

Finish



Reader finish



Technology platforms



Salto Space



–On-premise Network



Salto KS



–Cloud application



Salto Homelok



–Cloud application

Wireless technologies



Certifications



Carriers



Key Card

NXP MIFARE®
HID®



Key Fob

NXP MIFARE®

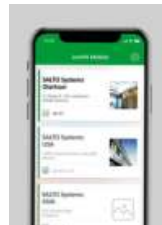

Digital Key

Bluetooth LE
NFC - Near Field Communication

Disclaimer:

For a complete description of the product range, verification of the availability and technical feasibility of the selected product, and a commercial offer, please get in touch with the local authorized SALTO dealer or a SALTO office.

SALTO Systems reserves the right to modify the product and its components.

Technical information and images displayed on the SALTO Systems product page are for informative purposes only and designed to inform about the main product features, options and technical specifications. Therefore, all images, illustrations, shapes, features, specifications, sizes, data, descriptions and colours shown on the SALTO Systems page shall consider as no-binding approximate indications only.