



Clever Little Box

SONET4: Cat5 Audio Distribution System - 4 in / 4 out

The highly successful 'So.net' Sound-over-Ethernet System has been designed to simplify and speed up installations where multiple microphone or line level inputs need to be situated a distance from the amplifier equipment.

Types of installation include churches, schools, theatres and corporate boardrooms.

This extremely versatile and cost effective installation device removes the need for multiple cable runs from remote audio inputs to the amplifier equipment. The SONET4 System can transmit up to four microphone or line level signals down one screened Cat5e cable for up to 1000m.

Each input and output can be independently configured for balanced or unbalanced signals as well as line level or microphone level. There is also an option to provide phantom power to the microphone inputs independently.

Each unit fits neatly into a standard UK double-gang back box and only requires a power supply at the output or amplifier end (PSU supplied as part of system).

Features:

- Reduces installation time
- Up to 1000m between Input and Output plates achievable
- Very high interference immunity
- Balanced or unbalanced inputs & outputs
- Line or Microphone level inputs & outputs
- Phantom power (max. 15v DC)
- Four XLR sockets on standard 2 gang plates
- No power required at input module
- Power Supply included as part of system

Please Note:

- When using Cat5 UTP (unshielded) cable, the So.Net system is only capable of transferring up to 3 channels. STP (shielded) Cat5 cable will allow for the maximum 4 channels.

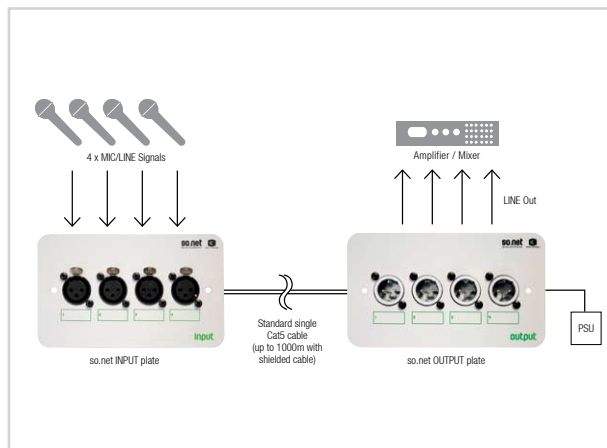
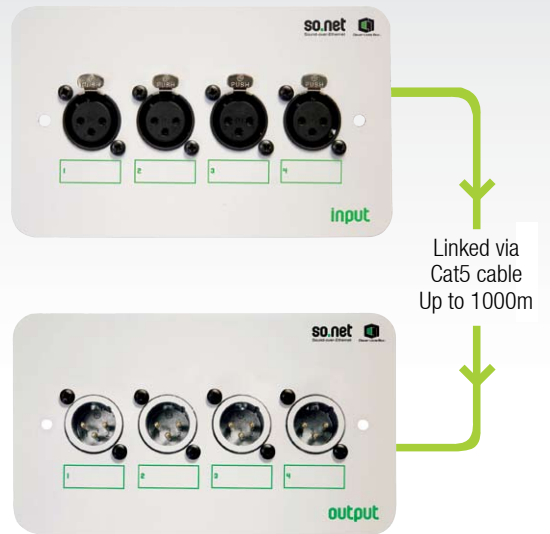

Specifications:

Input Module:	
Power	Over Cat5 cable
Ground	Over Cat5 cable screen (or spare pair)
Inputs x 4	Balanced XLR female
MIC/LINE in	Selectable by jumper
Phantom Power	15v jumper selectable
MIC Impedance	600Ω
MIC Level Input	10mv RMS
LINE Impedance	50kΩ
LINE Input Level	700mv RMS (1.5v RMS max)
Cat5 Termination	Screw terminals

Output Module:	
Power Requirements	24v DC @ 100mA (regulated linear power supply recommended)
Outputs x 4	Balanced XLR male
MIC/LINE Out	Selectable by jumper
MIC Out Impedance	600Ω
MIC Level Output	20mv RMS (into 600Ω)
LINE Out Impedance	20kΩ
LINE Level Output	700mv RMS (into 20K)

General:	
Channels	Four, individually configurable
Bandwidth	100Hz ~ 20kHz (-3dB)
Crosstalk	>60dB
Signal to Noise Ratio	>60dB
Cable Spec	Screened Cat5e cable (UTP can be used, but one pair required for ground, meaning only three channels would be available)
Cable Length	1000m maximum
Cat5 Termination	Screw terminals

Protected against short circuit on Cat5 cable to ground